



*Local to you - contactable when you need us*

 **KMJProperty**  
Your local independent Estate Agent



# Hatch End, Forest Row

Offers Over £485,000

3 2 1





Introducing this well-presented 3 double bedroom, 2 bathroom semi-detached property located in Forest Row. As you approach the property, you are greeted by a spacious driveway and extended garage, providing ample parking. As you step inside you enter the entrance hall with a built-in storage cupboard. To your right there is an exceptionally large and bright lounge area with two large windows that flood the room with natural light. The focal point is the feature fireplace, adding a touch of character to the space. The open kitchen/dining area provides ample upper and lower storage, counter-top space, space for appliances and built-in wall shelving. The dining area features a unique brick style wall, adding charm to the room. Off the kitchen there is a useful further single room / study room and the back door provides easy access to the rear garden terrace perfect for outdoor entertaining.

Heading upstairs, you will find three double bedrooms, all generously sized and boasting large windows. The main bedroom and third bedroom are equipped with built-in storage cupboards for added convenience. There is a spacious part boarded loft with a built in loft ladder. The first floor also features a separate shower room and a particularly spacious bathroom. The shower room offers a WC and electric shower cubicle, while the main bathroom includes a bath, WC, and pedestal wash basin. Lastly the rear garden includes a paved terrace, perfect for summer furniture and BBQ evenings. As well as an easily maintained lawn area surrounded by mature shrubs and trees, a fish pond and a lower graveled area.

Forest Row benefits from excellent transport links, with easy access to major road networks and public transportation options, including bus services. East Grinstead railway station provides direct connections to London, making Forest Row the ideal commuter village. Situated on the edge of Ashdown Forest, there are endless opportunities for walks directly from the house, as well as cycling. It is a short walk to the Royal Ashdown Golf Course, Forest Row Lawn Tennis Club, Forest Row Cricket and Football. The property is located close to a range of amenities, including independent shops, organic delicatessens and farm shops, supermarkets, cafes, restaurants, and recreational areas and schools including, Forest Row Primary & Michael Hall (Steiner School).



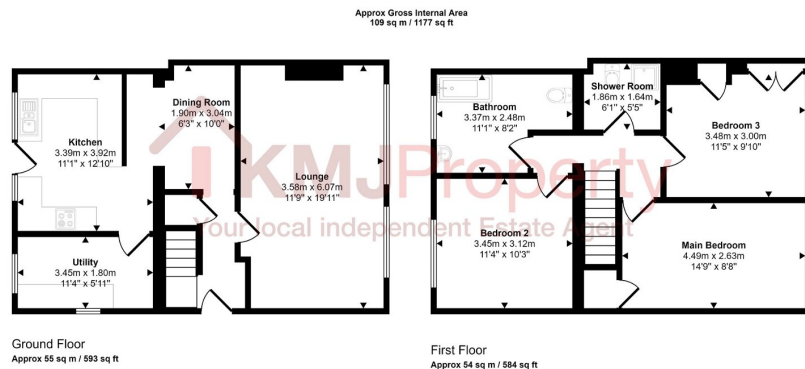

This floorplan is only for illustrative purposes and is not to scale. Measurements of rooms, doors, windows, and any items are approximate and no responsibility is taken for any error, omission or mis-statement. Icons of items such as bathroom suites are representations only and may not look like the real items. Made with Made Simple 360.

- 3 Double Bedrooms
- Semi Detached
- Driveway
- Garage
- Rear Garden
- Forest Row
- Council Tax D
- EPC D

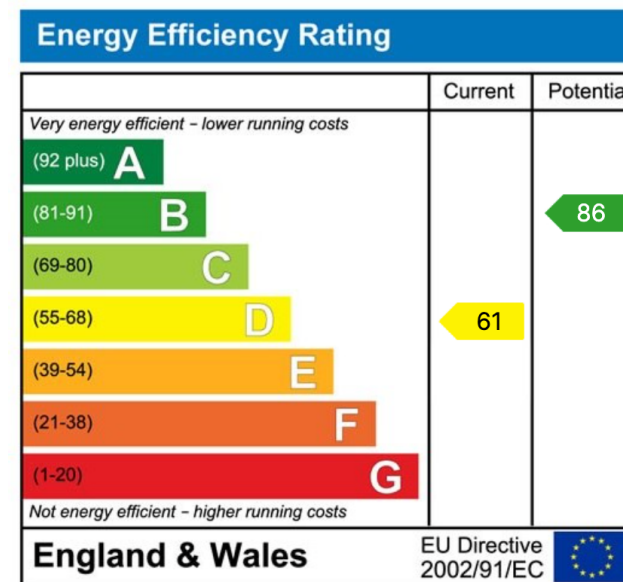

📞 01892 515188

Offices in Tunbridge Wells & Crowborough

📧 sales@kmjproperty.co.uk

🌐 www.kmjproperty.co.uk